

## iWire DCCDPro Spider Plug and Play Kit Install Guide for STi Cluster

### Cluster Sub Harness with Pins for STi Cluster



## iWire DCCDPro Spider Plug and Play Kit Install Guide for STi Cluster

The first step is getting access to your cluster. To do this, remove the bezel surround using a small screwdriver and unscrewing the two screws in the top of the bezel.



Once unscrewed, the bezel should pop out with a slight pull.



## iWire DCCDPro Spider Plug and Play Kit Install Guide for STi Cluster

Then unscrew your cluster until you can pull it out slightly and get access to the plugs on the top of the unit. There should be one screw at the top and two screws near each bottom corner.



Unplug the needed connector. (see below for which cluster plug is needed for your specific car).

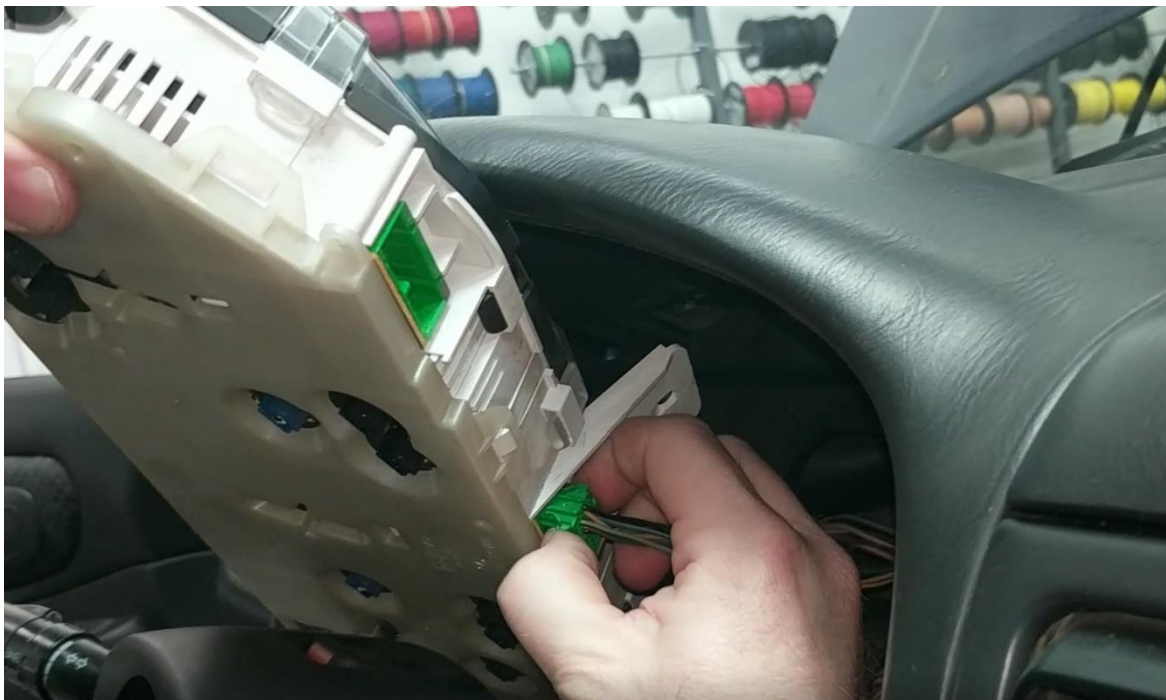



## iWire DCCDPro Spider Plug and Play Kit Install Guide for STi Cluster

Next you will insert the wires into the cluster plug. First remove the locks on the top and bottom of the cluster plug to install the pins. You can do this with a small pick or screwdriver.

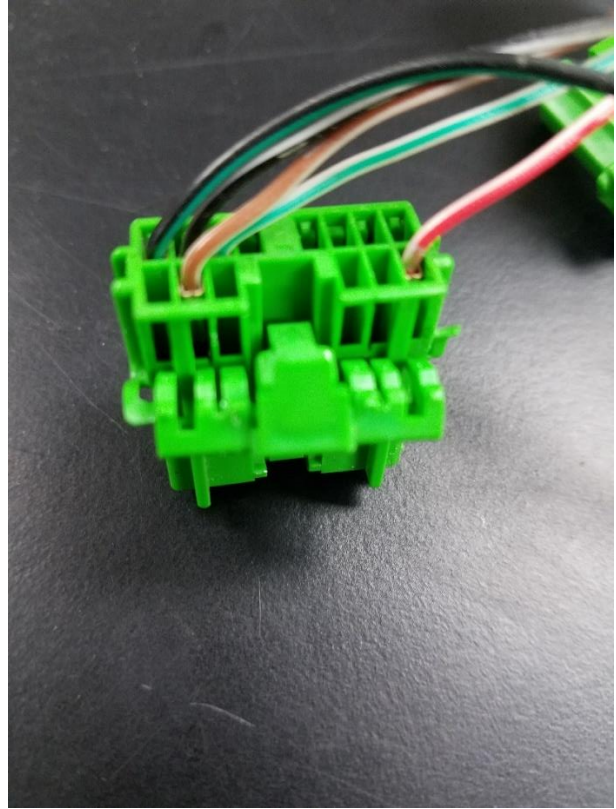
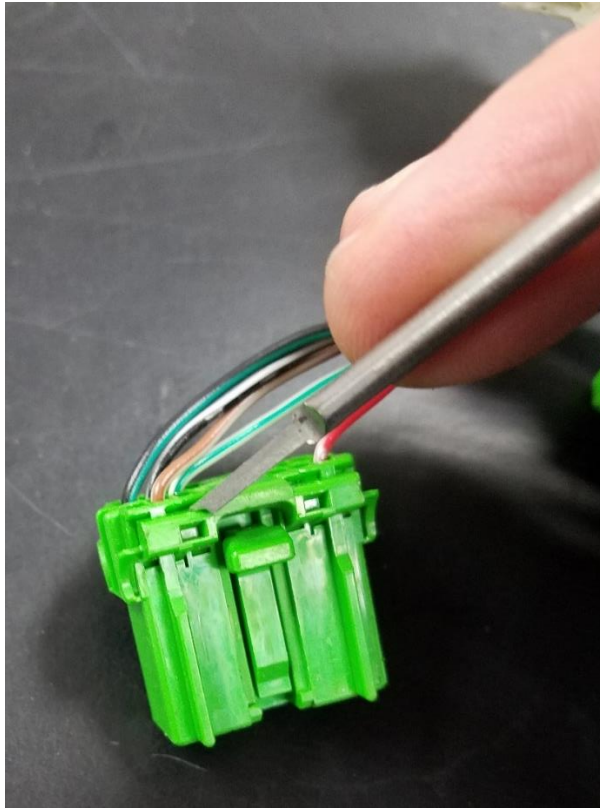

## iWire DCCDPro Spider Plug and Play Kit Install Guide for STi Cluster

You'll then insert the pins from the cluster jumper (shown above) into the A cluster plug. These slots should already be empty in your cluster plug. See below for wire order. Slot each pin until you hear a slight click and the pin doesn't pull out with a slight tug.

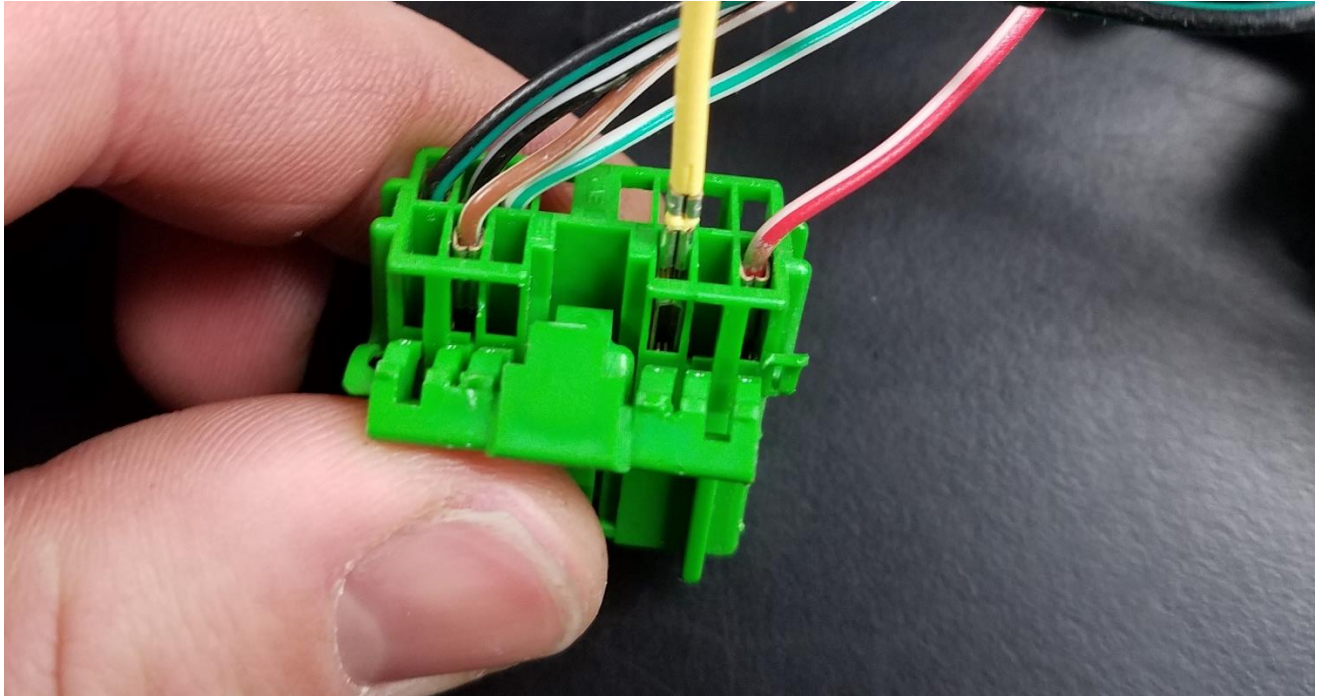

## 2001-2004 STi Cluster

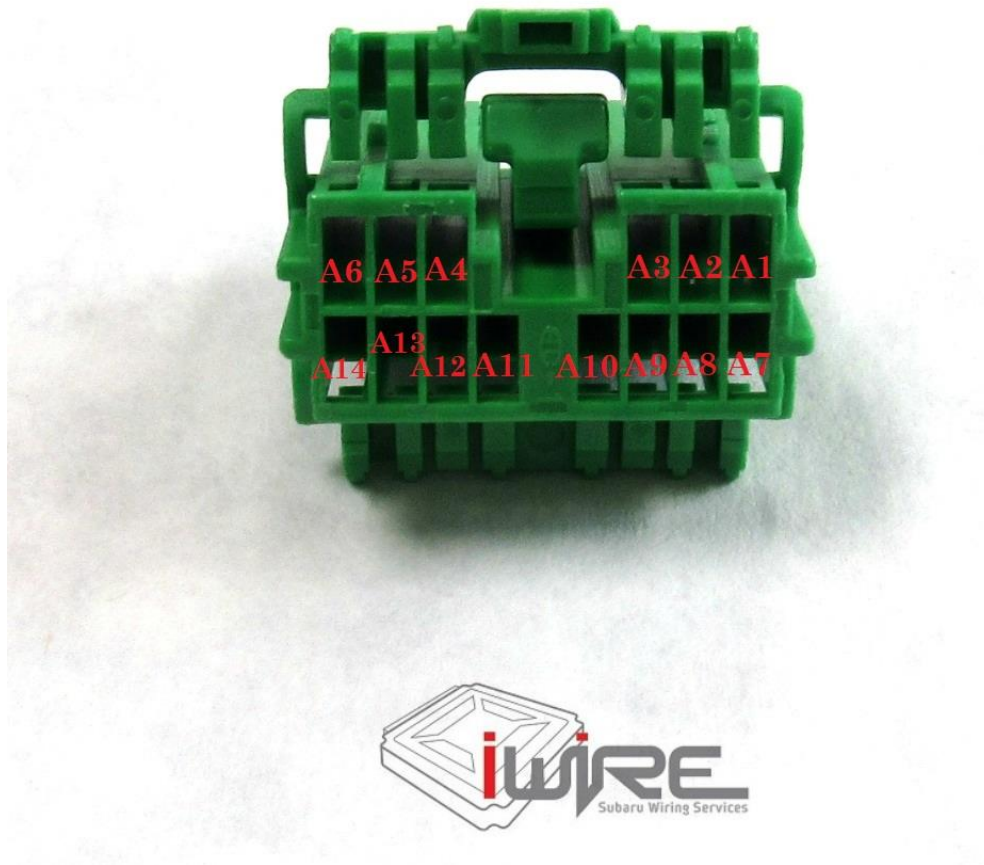

**\*Please note this picture is of the back of the plug**

A4 – Yellow

A5 - Green

A10 – Orange

A11 – Red

A12 – Blue

A13 – Brown

A14 – White

\* If your cluster jumper included a black wire, please depin that wire as it is not needed for this model.

# iWire DCCDPro Spider Plug and Play Kit Install Guide for STi Cluster

## 2005-2007 STi Cluster



**\*Please note this picture is of the back of the plug**

A5 – Yellow

A6 – Green

A12 – Orange

A13 – Red

A14 – Blue

A15 – Brown

A16 - White

\* If your cluster jumper included a black wire, please depin that wire as it is not needed for this model.

## iWire DCCDPro Spider Plug and Play Kit Install Guide for STi Cluster

Once all the of the wires are inserted correctly, use a small pick tool or screwdriver to push in the two locks on top and bottom of the green cluster plug.

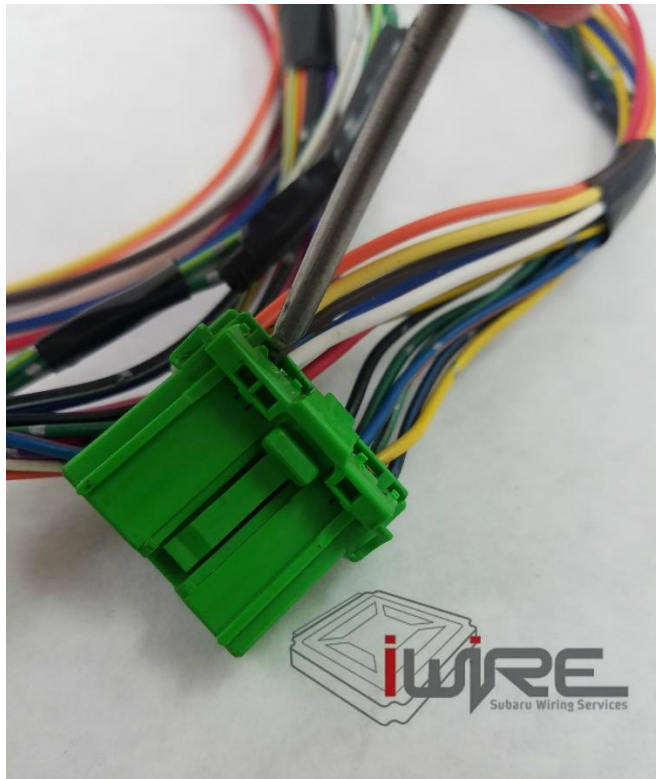

To finish you DCCD Cluster install, plug the cluster plug back into the cluster. Plug the white plug end of the cluster jumper provided in your kit into the matching receptacle on your DCCD. Tuck all of the loose wiring behind the cluster. Reinstall the cluster similar to how you removed it. Plug in all wires, tuck them neatly behind cluster, put cluster back into place and reinsert the three screws, push in bezel surround and reinsert two screws to hold it in place.

If you have any questions during your cluster install, please don't hesitate to ask us!